



A 84 PASSIVHAUS HI - PVC

ENERGY EFFICIENCY

Thermal Transmission Coefficient

U_w from 0.66 (W/m²K)

Please consult typology, dimensions and glazing.

ACCOUSTIC INSULATION

Maximum glazing: **56 mm**

Maximum acoustic insulation: **Rw = 46 dB**

CATEGORIES ACHIEVED AT TEST CENTRE

Protection against atmospheric agents

Air permeability (UNE-EN 12207:2000):

Class 4

Water tightness (UNE-EN 12208:2000):

Class E1500

Wind resistance (UNE-EN 12210:2000):

Class C5

Reference test window 1.23 x 1.48 m. 2 sashes.

| | | | | | |
|---------------------|--|-------------------|----------------------|---|--|
| SECTIONS | Frame 84 mm Sash 84 mm | | GASKETS | EPDM Triple GASKET | |
| CLASIFICATION | Profile thickness Class A ≥ 2.8 mm Weather Severe weather Impact Class II | | OPENING POSIBILITIES | | |
| MAXIMUM DIMENSIONS | Width (L) = 450-1,300 mm Height (H) = 450-2,200mm Window | | INWARDS | Side hung, turn&tilt, parallel tilt, tilt. | |
| | Width (L) = 450-1,300 mm Height (H) = 600-2,200 mm Balcony | | FINISHES | Optionally bicoloured White Smooth colours Wood-imitation effect | |
| MAXIMUM WEIGHT/SASH | 100 Kg Window | 100 Kg Balcony | | | |

Please consult maximum dimensions according to types.

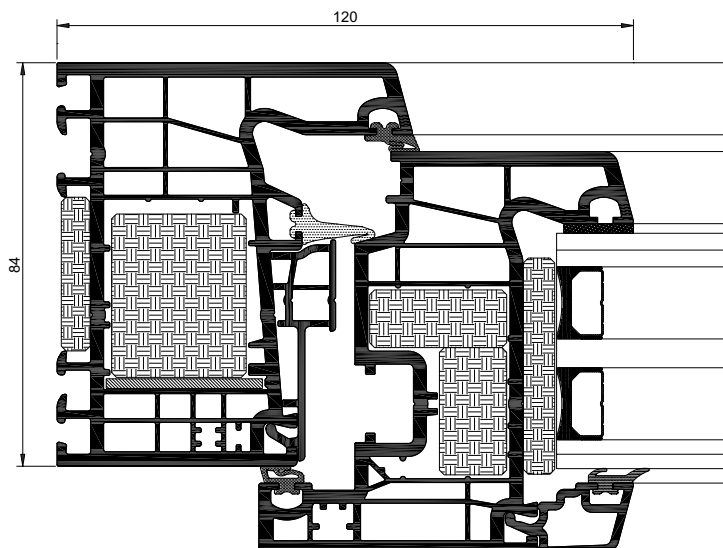



A 84 PASSIVHAUS 1.0 - PVC

ENERGY EFFICIENCY

Thermal Transmission Coefficient

U_w from 0.74 (W/m²K)

Please consult typology, dimensions and glazing.

ACCOUSTIC INSULATION

Maximum glazing: **54 mm**

Maximum acoustic insulation: **Rw = 46 dB**

CATEGORIES ACHIEVED AT TEST CENTRE

Protection against atmospheric agents

Air permeability (UNE-EN 12207:2000):

Class 4

Water tightness (UNE-EN 12208:2000):

Class E1500

Wind resistance (UNE-EN 12210:2000):

Class C5

Reference test window 1.23 x 1.48 m. 2 sashes.

| | | | | | |
|---------------------|--|-------------------|----------------------|---|--|
| SECTIONS | Frame 84 mm Sash 84 mm | | GASKETS | EPDM Triple GASKET | |
| CLASIFICATION | Profile thickness Class A ≥ 2.8 mm Weather Severe weather Impact Class II | | OPENING POSIBILITIES | INWARDS Side hung, turn&tilt, parallel tilt, tilt, bottom hung. | |
| MAXIMUM DIMENSIONS | Width (L) = 450-1,400 mm Height (H) = 450-2,200mm Window | | FINISHES | Optionally bicoloured White Smooth colours Wood-imitation effect | |
| | Width (L) = 650-1,400 mm Height (H) = 600-2,400 mm Balcony | | | | |
| MAXIMUM WEIGHT/SASH | 130 Kg Window | 130 Kg Balcony | | | |

Please consult maximum dimensions according to types.

